

# Smart lift SL380







Product information and specifications

# Smart lift SL380

## STANDARD EQUIPMENT

- Electric actuators secure precise installation
- Side shift 100 mm to each side
- Reliable 2 circuit vacuum system
- Easy to handle
- Recognized danish quality
- 500 W propeling engine
- Improves work environment
- Multi functional
- It is easy to transport by its own force over a platform in any van or trailer
- SmartLift was honoured with Swedish prize for improving work environment in 2007

## DIMENSIONS

	Width (min) .....	<b>650 mm</b>
	Length (min) .....	<b>2100 mm</b>
	Extention of arm .....	<b>500 mm</b>
	Side shift .....	<b>100 mm</b>
	Height .....	<b>1350 mm</b>
	Tip from horizontal .....	<b>50° backwards / 100° forward</b>
	Propelling engine .....	<b>500 Watt</b>
	Battery (2 x 12 V) 24 Volt .....	<b>2 x 60 A</b>
	Running period .....	<b>Approx. 30 hours</b>
	Integrated charger .....	<b>Cetek XT 14000</b>
	Charging time .....	<b>Approx. 8 hours</b>
	Voltage charger .....	<b>230 volt</b>
	Vacuum system .....	<b>2 circuits</b>
	Suction pads .....	<b>4 x Ø300 mm</b>
	Automatic suction .....	<b>Yes</b>
	Weight .....	<b>570 kg</b>

## LOADING DIAGRAM

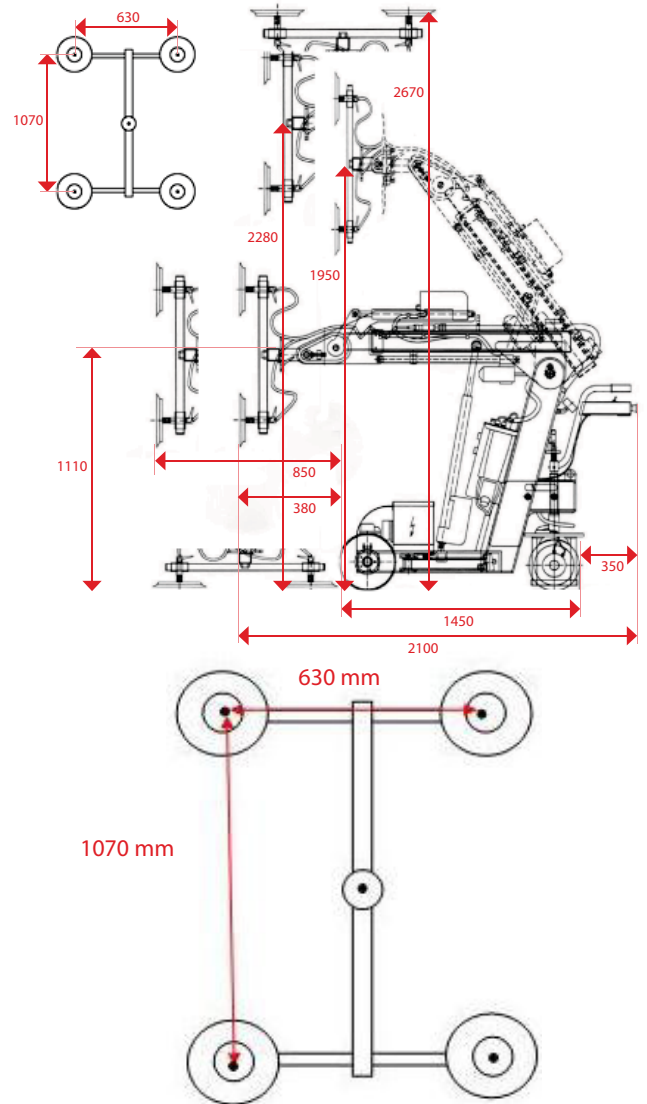

[www.instant.no](http://www.instant.no)

**INSTANT**

**Norway**

Tel.: +47 23 19 11 00  
info@instant.no

**Lithuania**

Tel.: +370 5 233 1096  
info@instant.lt

**Latvia**

Tel.: + 371 263 58 152  
info@instantlatvija.lv

**Estonia**

Tel.: +372 680 76 33  
info@instant.ee